

SANA  METROPOLITAN  
★★★★

SANA  METROPOLITAN  
★★★★ Excellence Concept Hotel

CLOSER TO  
COSMOPOLITAN  
LISBON

BUSINESS PORTFOLIO







# WELCOME TO SANA METROPOLITAN

SANA Metropolitan is a cosmopolitan hotel that offers you special comfort on your leisure and business trips to Lisbon.

# SPACIOUS AND CONTEMPORARY

*LOCATED IN FULL BUSINESS  
AND ACADEMIC AREA OF LISBON*

With a prime and central location, between Praça de Espanha, Zoo and Cidade Universitária, SANA Metropolitan is a grand cosmopolitan hotel, distinguished by its large spaces and contemporary decor, but mainly by its priority to provide you with all the comfort and excellent service throughout your stay.

\_ HOTEL ENVIRONMENT



- 4 Twin Rooms for guests with reduced mobility
- 5 Elevators
- Electricity: 220 volts
- Air conditioning
- Breakfast room
- Wireless Internet
- Laundry/ Dry cleaning
- Car Park | Valet parking
- Multilingual Staff
- 24h Reception
- ATM Currency Exchange
- City tours
- Rent-a-car
- Tobacco shop and souvenir shop
- Tour desk
- Gymnasium

Hotel Services  
Facilities \_





\_ LOBBY



\_ RECEPTION



\_ LOBBY



# CENTRAL LOCATION

*NEXT TO THE MAIN ROADS  
THAT CONNECT THE CITY*

With a strategic location next to Praça de Espanha and Sete Rios (Lisbon Zoo), SANA Metropolitan Hotel benefits from excellent access to public transportation, including different metro and train lines.

10 minutes from Praça Marquês de Pombal and downtown Lisbon, the Hotel has a privileged location close to the main stadiums, shopping centres in Lisbon and the university's campus.

## \_ SURROUNDING AREA



## \_ TEMPERATURE

 SPRING | 20°C ▲▼ 15°C

 SUMMER | 32°C ▲▼ 18°C

 AUTUMN | 17°C ▲▼ 12°C

 WINTER | 15°C ▲▼ 9°C

Calouste Gulbenkian Museum

Zoo

Cidade Universitária

Campo Pequeno

El Corte Inglés

Marquês de Pombal

Castle of São Jorge

Graça

Alfama

Jerónimos

Torre de Belém

## ACCESS

Metro, Train and bus

Eixo Norte-Sul and Expressways

Lisbon Airport (LIS)

## Surrounding Area\_

# SANA METROPOLITAN ON THE MAP

ACCESS TO ALL CENTRAL POINTS OF LISBON

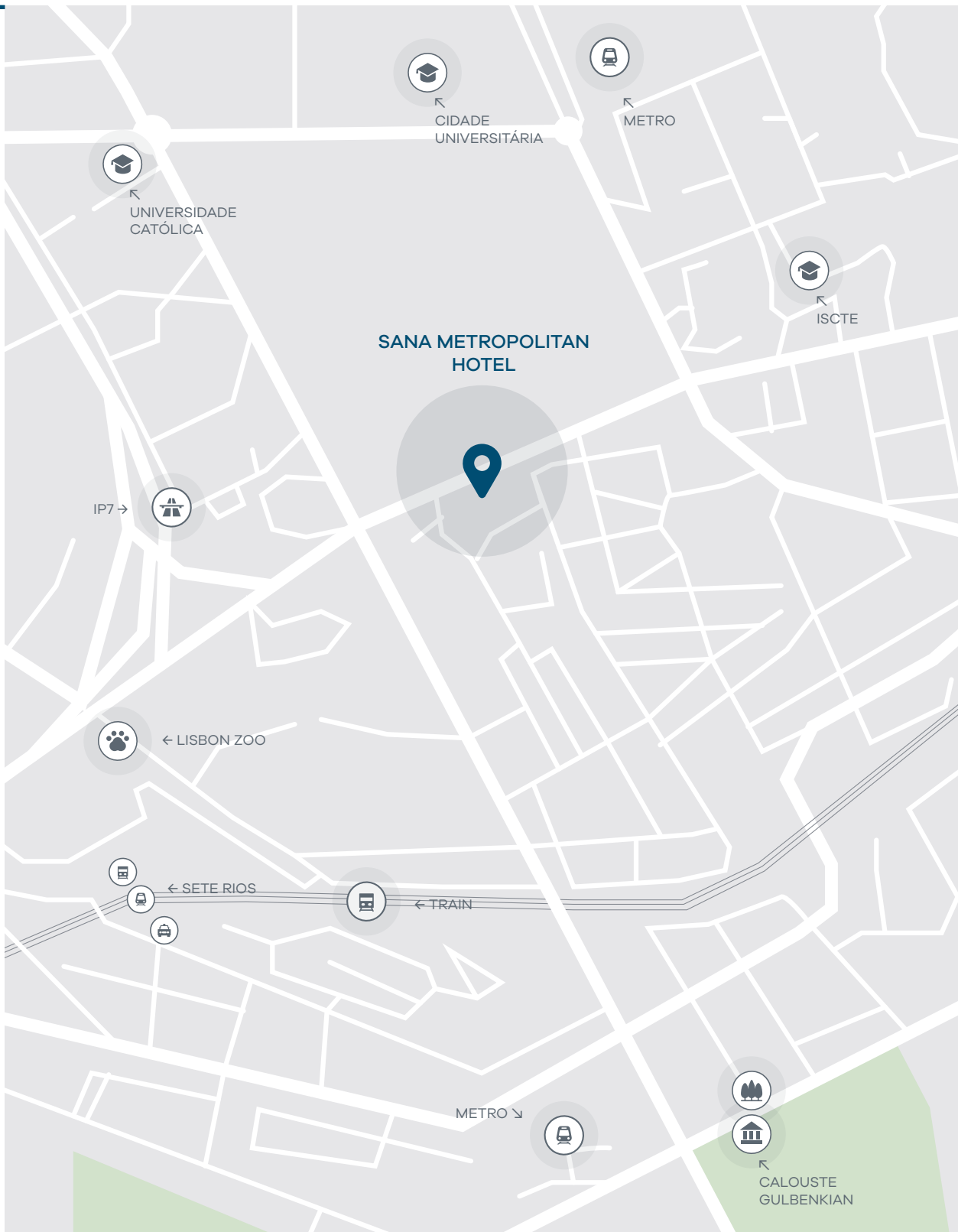

# ACCOMMODATION

*A TRUE COMFORT ZONE*

Bright and with all the space you need, the contemporary design rooms are a true comfort zone.

A total of 315 rooms, all of which have a work desk, free Wi-Fi, and LCD TV with cable channels, among other equipment. Superior rooms and suites offer extra space and facilities, with a high level of comfort.

53 / DUPLOS

128 / TWIN FLEX

125 / TWINS

9 / SUITES



**Services  
Facilities\_**

\_ WELCOME PACK



- Air conditioning with individual control
- Wireless Internet
- Side table / worktable
- Digital safe box
- Full HD LCD
- Cable TV
- Magnifying and make-up mirror
- Hairdryer
- One 110 volts shaver Plug in the WC
- Telephone
- Minibar
- Room service 24h
- Wake up service
- Double glazed Windows
- USB inputs for device charging



\_ SUITE / ROOM



\_ SUITE / BEDROOM



\_ SUITE / BEDROOM





# FOOD AND BEVERAGES

*THE BEST FLAVOURS FROM  
THE MEDITERRANEAN*

The Astrolábio restaurant and terrace invite you on a journey of flavours inspired by Portuguese cuisine.

At the Wall Street Bar, you can have a coffee, enjoy a glass of wine and a snack, or a drink, all night long. The sound of live piano gives life to the bar where work and pleasure coexist harmoniously.

\_ WALL STREET BAR



\_ ASTROLÁBIO RESTAURANT





\_ ASTROLÁBIO RESTAURANT



\_ BUFFET



\_ TERRACE





# FITNESS CENTER

*24 HOURS A DAY AT YOUR DISPOSAL*

We want you to keep your daily exercise routine. That's why we make sure you have everything you need to stay in great shape.

Enjoy natural light and state-of-the-art Technogym equipment for strength and cardio training, 24/7.

\_ EQUIPMENT ROOM



\_ EQUIPMENT ROOM



# MEETINGS SPACES

*THE PERFECT SETTING FOR YOUR EVENT*

The SANA Metropolitan offers the perfect location and the ideal environment for those visiting the city on business.

Workshops, congresses, business lunches or dinners, weddings or even late afternoon cocktails, everything is possible here.

We have 2 floors solely dedicated to business and social events, with a total of 12 rooms with a terrace or natural light and all the services and facilities you may need. The total area of the space is 1750 sqm and can fit up to 600 people.

## \_ EVENTS



## \_ MADRID MEETING ROOM



- Access for people with reduced mobility
- Natural light
- Room air conditioning
- Coffee station, coffee break, cocktail, served menus and buffet
- Free Wi-Fi access
- Detachable dividers

### Audiovisual Material

- Screen
- Projector
- Flipchart
- LED HD 130' screens

## Features\_



A photograph of a modern conference room. A long, light-colored wooden conference table is the central focus, surrounded by matching wooden chairs with black seats. On the table, there are several water bottles (some clear, some green) and small trays with lemons. At the far end of the table, a large black screen is mounted on a stand. The room has a striped carpet, a drop ceiling with recessed lights, and two abstract paintings on the wall. The overall lighting is soft and professional.

# MICE

Grand and cosmopolitan, the Hotel is the perfect location for your event, with large, welcoming, and well-equipped spaces, and excellent service.

# MEETINGS, CONGRESSES AND EVENTS









*FLEXIBLE AND MODULAR SPACES*

The SANA Metropolitan Hotel offers the perfect location and the ideal environment for those visiting the city on business.

12 Flexible rooms with solutions for all events, congresses or meetings of any size, with audiovisual equipment and all the facilities and services you need.



## Features and Services\_

-  Audiovisual Material
-  Access for people with reduced mobility
-  Natural Light
-  Air conditioning of the rooms
-  Coffee Station, Coffee Break, Cocktail, Served menus and Buffets
-  Free Wi-Fi
-  Removable Partitions
-  Flipcharts



\_ MADRID ROOM CABARET



\_ PARIS ROOM THEATRE



# FLOOR 1

FULLY FLEXIBLE SPACES

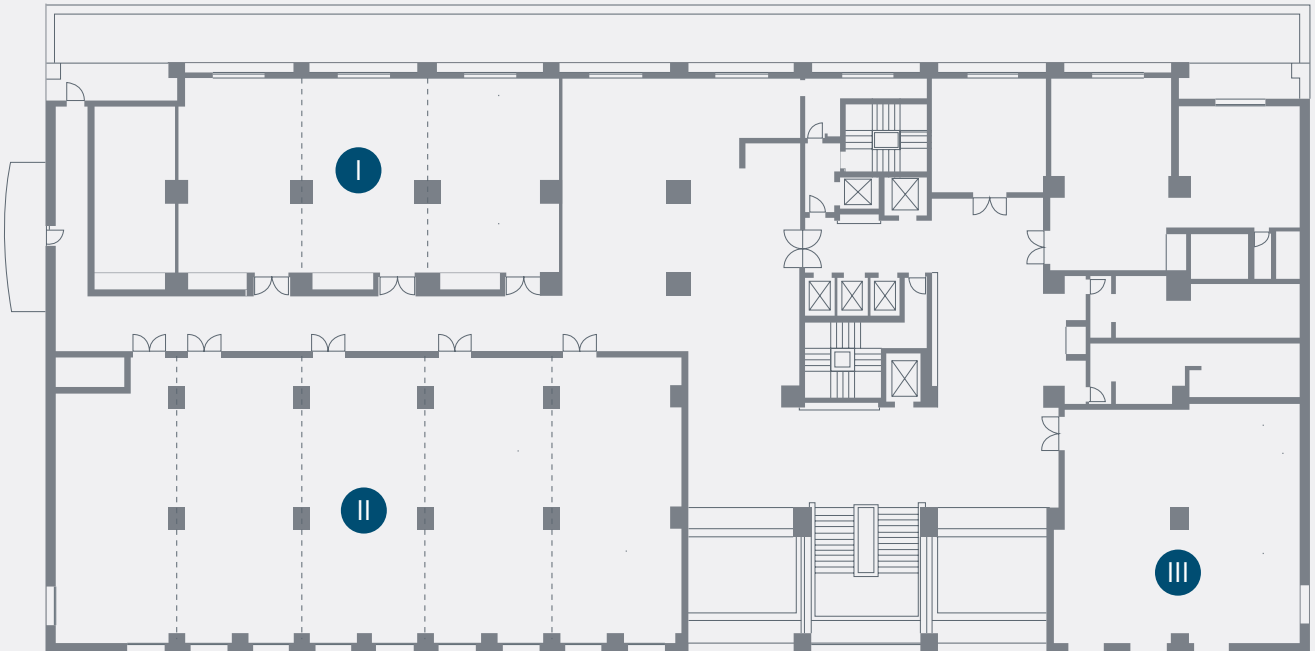

Total Area  
860 sqm

- I Lisboa 233 sqm
- II Madrid 476 sqm
- III Paris 156 sqm



# FLOOR 1

## ROOM CAPACITIES AND SPECIFICATIONS

	Area	Dimensions	 Theatre	 Theatre double proj.	 Classroom	 Classroom double proj.	 Cabaret	 U Shape	 O Shape	 Cocktail	 Banquet	 Buffet
Lisboa A	63 sqm	6,5 m x 9,7 m	40	-	24	-	24	18	24	50	40	30
Lisboa B	63 sqm	6,5 m x 9,7 m	40	-	24	-	24	18	24	50	40	30
Lisboa C	63 sqm	6,5 m x 9,7 m	-	-	-	-	-	-	15	-	-	-
Lisboa A + B + C	233 sqm	9,7 m x 24,5 m	100	-	65	-	-	-	-	150	120	90
Madrid A	96 sqm	6,6 m x 14,5 m	90	-	54	-	36	36	46	80	70	50
Madrid B	96 sqm	6,5 m x 14,5 m	90	-	54	-	36	36	46	80	70	50
Madrid C	96 sqm	6,5 m x 14,5 m	90	-	54	-	36	36	46	80	70	50
Madrid D	96 sqm	6,5 m x 14,5 m	90	-	54	-	36	36	46	80	70	50
Madrid E	92 sqm	6,3 m x 14,5 m	80	-	42	-	30	30	36	70	50	40
Madrid A+B+C+D+E	476 sqm	32,8 m x 14,5 m	-	-	-	-	-	-	-	300	300	260
Paris	156 sqm	12 m x 13 m	100	150	90	130	60	36	42	110	120	70

# FLOOR 1

## GENERAL FEATURES

### LISBOA A ROOM

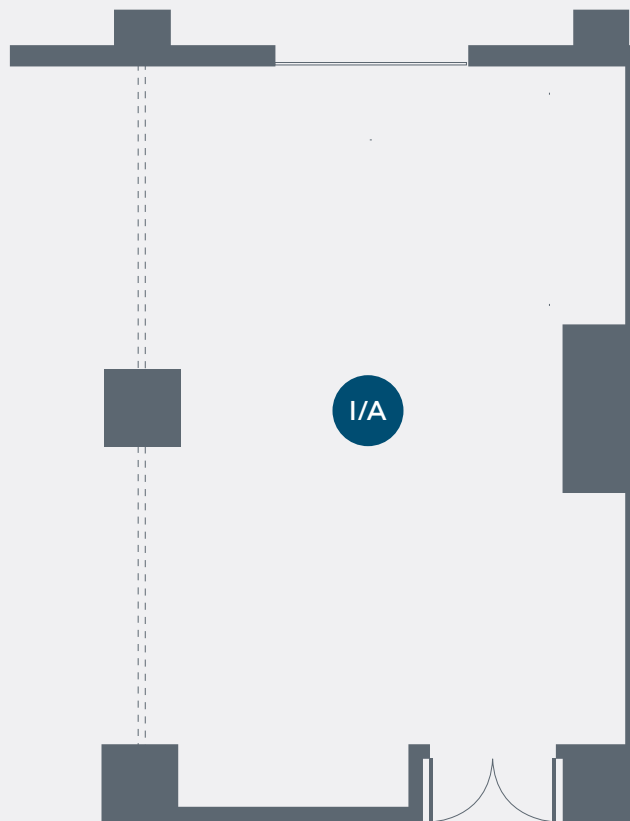

#### DIMENSIONS

Area: 63 sqm  
 Column: -  
 Length: 9.7 m  
 Width: 6.5 m  
 Height (ceiling): 2.55 m

#### ENTRYWAYS

Doors: 1  
 Door Height: 2 m  
 Door Width: 1.4 m

#### AIR CONDITIONING AND LIGHTING

Air conditioned: Yes  
 Natural light: Yes  
 Blackout: Yes

#### DATA AND VOICE

ISDN Connection: Yes  
 Telephone connection: Yes

#### LINKS

Electrical Sockets: 8  
 TV Antennas: 1  
 Telephone sockets: 1  
 Internet sockets: 1  
 Voltage: 220  
 Amps: 10

#### EQUIPMENT AVAILABLE INCLUDED IN THE PRICE:

Mineral water, pens, paper, screen, flipchart and projector

#### EQUIPMENT AVAILABLE

#### NOT INCLUDED IN THE PRICE:

Mixer, speakers and microphones (table, handheld, headset)



# FLOOR 1

## GENERAL FEATURES LISBOA B ROOM

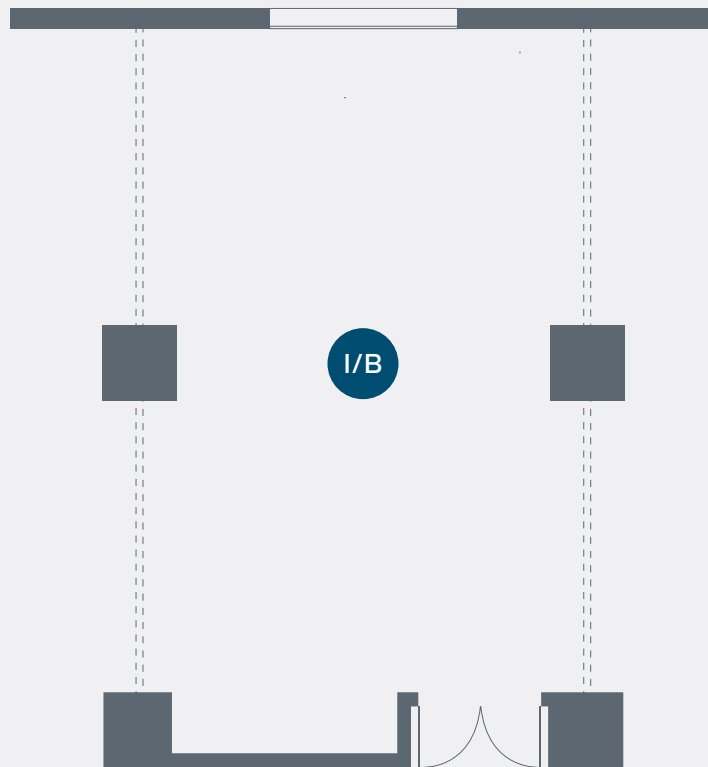

### DIMENSIONS

Area: 63 sqm  
 Column: -  
 Length: 9.7 m  
 Width: 6.5 m  
 Height (ceiling): 2.55 m

### ENTRYWAYS

Doors: 1  
 Door Height: 2 m  
 Door Width: 1.4 m

### AIR CONDITIONING AND LIGHTING

Air conditioned: Yes  
 Natural light: Yes  
 Blackout: Yes

### DATA AND VOICE

ISDN Connection: Yes  
 Telephone connection: Yes

### LINKS

Electrical Sockets: 7  
 TV Antennas: 1  
 Telephone sockets: 1  
 Internet sockets: 1  
 Voltage: 220  
 Amps: 10

### EQUIPMENT AVAILABLE INCLUDED IN THE PRICE:

Mineral water, pens, paper, screen, flipchart and projector

### EQUIPMENT AVAILABLE NOT INCLUDED IN THE PRICE:

Mixer, speakers and microphones (table, handheld, headset)

# FLOOR 1

## GENERAL FEATURES LISBOA C ROOM

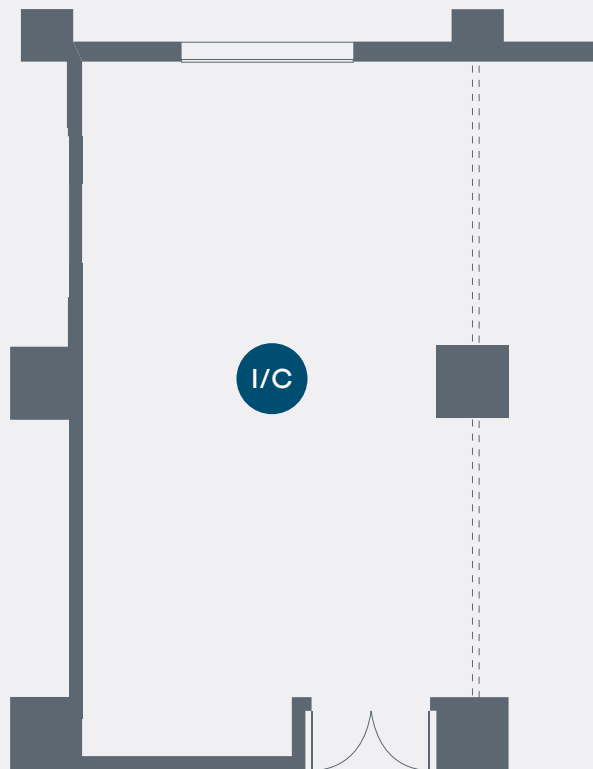

### DIMENSIONS

Area: 63 sqm  
 Column: -  
 Length: 9.7 m  
 Width: 6.5 m  
 Height (ceiling): 2.55 m

### ENTRYWAYS

Doors: 1  
 Door Height: 2 m  
 Door Width: 1.4 m

### AIR CONDITIONING AND LIGHTING

Air conditioned: Yes  
 Natural light: Yes  
 Blackout: Yes

### DATA AND VOICE

ISDN Connection: Yes  
 Telephone connection: Yes

### LINKS

Electrical Sockets: 7  
 TV Antennas: 1  
 Telephone sockets: 1  
 Internet sockets: 1  
 Voltage: 220  
 Amps: 10

### EQUIPMENT AVAILABLE INCLUDED IN THE PRICE:

Mineral water, pens, paper, screen, flipchart and projector

### EQUIPMENT AVAILABLE NOT INCLUDED IN THE PRICE:

Mixer, speakers and microphones (table, handheld, headset)



# FLOOR 1

## GENERAL FEATURES MADRID A ROOM

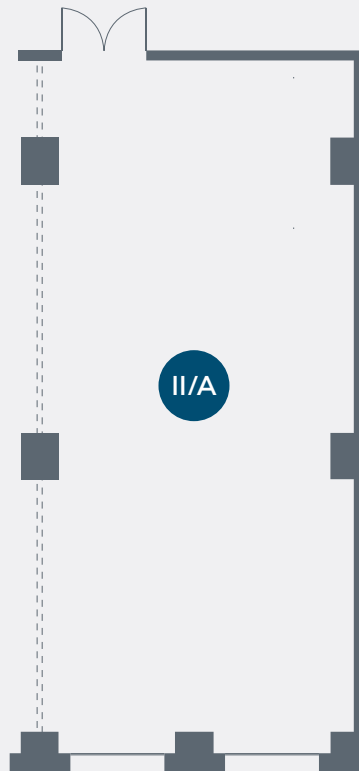

### DIMENSIONS

Area: 96 sqm  
 Column: -  
 Length: 14.5 m  
 Width: 6.6 m  
 Height (ceiling): 2.55 m

### ENTRYWAYS

Doors: 1  
 Door Height: 2 m  
 Door Width: 1.4 m

### AIR CONDITIONING AND LIGHTING

Air conditioned: Yes  
 Natural light: Yes  
 Blackout: Yes

### DATA AND VOICE

ISDN Connection: Yes  
 Telephone connection: Yes

### LINKS

Electrical Sockets: 8  
 TV Antennas: 1  
 Telephone sockets: 1  
 Internet sockets: 1  
 Voltage: 220  
 Amps: 10

### EQUIPMENT AVAILABLE INCLUDED IN THE PRICE:

Mineral water, pens, paper, screen, flipchart and projector

### EQUIPMENT AVAILABLE NOT INCLUDED IN THE PRICE:

Mixer, speakers and microphones (table, handheld, headset)

# FLOOR 1

## GENERAL FEATURES MADRID B ROOM

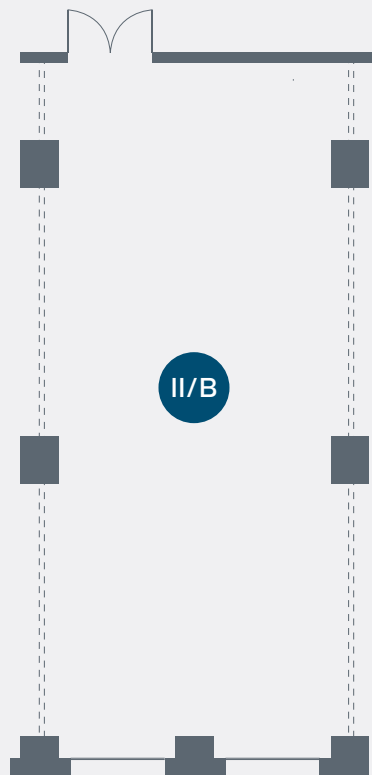

### DIMENSIONS

Area: 96 sqm  
 Column: -  
 Length: 14.5 m  
 Width: 6.5 m  
 Height (ceiling): 2.55 m

### ENTRYWAYS

Doors: 1  
 Door Height: 2 m  
 Door Width: 1.4 m

### AIR CONDITIONING AND LIGHTING

Air conditioned: Yes  
 Natural light: Yes  
 Blackout: Yes

### DATA AND VOICE

ISDN Connection: Yes  
 Telephone connection: Yes

### LINKS

Electrical Sockets: 8  
 TV Antennas: 1  
 Telephone sockets: 1  
 Internet sockets: 1  
 Voltage: 220  
 Amps: 10

### EQUIPMENT AVAILABLE INCLUDED IN THE PRICE:

Mineral water, pens, paper, screen, flipchart and projector

### EQUIPMENT AVAILABLE

#### NOT INCLUDED IN THE PRICE:

Mixer, speakers and microphones (table, handheld, headset)

# FLOOR 1

## GENERAL FEATURES MADRID C ROOM

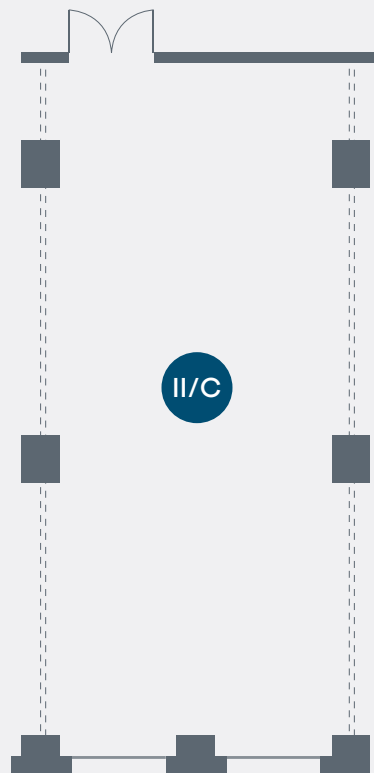

### DIMENSIONS

Area: 96 sqm  
 Column: -  
 Length: 14.5 m  
 Width: 6.5 m  
 Height (ceiling): 2.55 m

### ENTRYWAYS

Doors: 1  
 Door Height: 2 m  
 Door Width: 1.4 m

### AIR CONDITIONING AND LIGHTING

Air conditioned: Yes  
 Natural light: Yes  
 Blackout: Yes

### DATA AND VOICE

ISDN Connection: Yes  
 Telephone connection: Yes

### LINKS

Electrical Sockets: 8  
 TV Antennas: 1  
 Telephone sockets: 1  
 Internet sockets: 1  
 Voltage: 220  
 Amps: 10

### EQUIPMENT AVAILABLE INCLUDED IN THE PRICE:

Mineral water, pens, paper, screen, flipchart and projector

### EQUIPMENT AVAILABLE

#### NOT INCLUDED IN THE PRICE:

Mixer, speakers and microphones (table, handheld, headset)



# FLOOR 1

## GENERAL FEATURES MADRID D ROOM

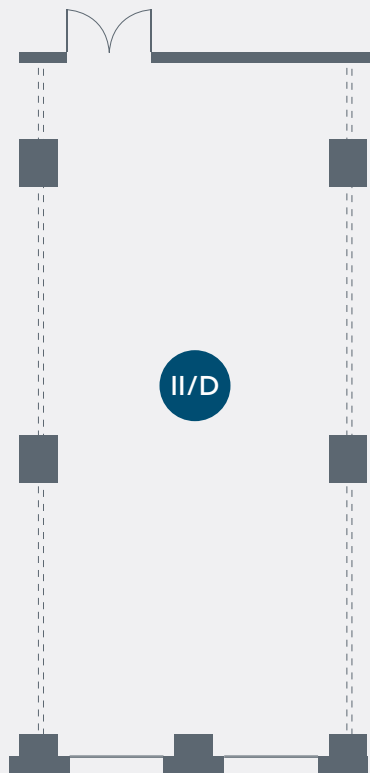

### DIMENSIONS

Area: 96 sqm  
 Column: -  
 Length: 14.5 m  
 Width: 6.5 m  
 Height (ceiling): 2.55 m

### ENTRYWAYS

Doors: 1  
 Door Height: 2 m  
 Door Width: 1.4 m

### AIR CONDITIONING AND LIGHTING

Air conditioned: Yes  
 Natural light: Yes  
 Blackout: Yes

### DATA AND VOICE

ISDN Connection: Yes  
 Telephone connection: Yes

### LINKS

Electrical Sockets: 8  
 TV Antennas: 1  
 Telephone sockets: 1  
 Internet sockets: 1  
 Voltage: 220  
 Amps: 10

### EQUIPMENT AVAILABLE INCLUDED IN THE PRICE:

Mineral water, pens, paper, screen, flipchart and projector

### EQUIPMENT AVAILABLE NOT INCLUDED IN THE PRICE:

Mixer, speakers and microphones (table, handheld, headset)

\_ TERRACE 1<sup>ST</sup> FLOOR

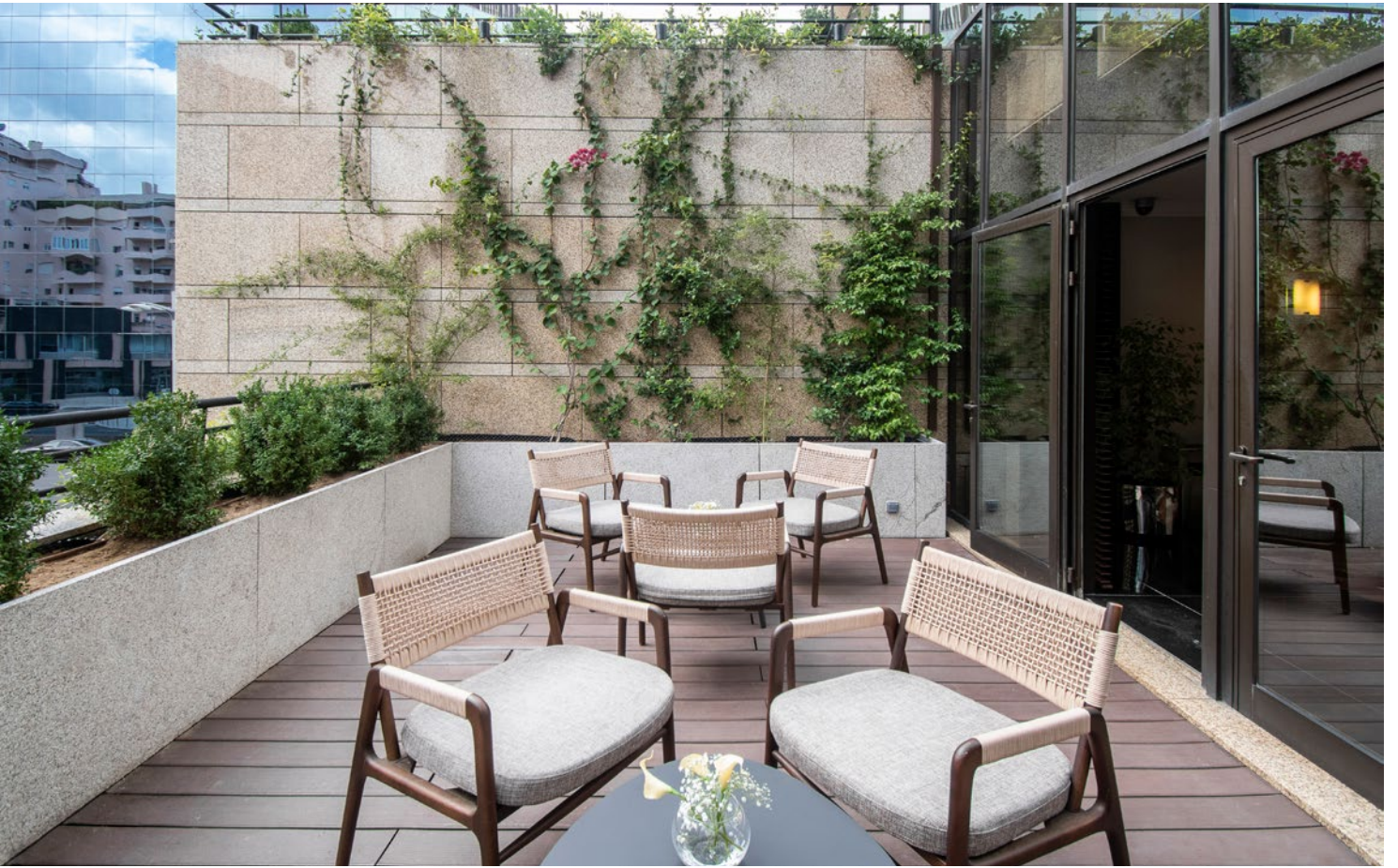

\_ TERRACE 1<sup>ST</sup> FLOOR



\_ COFFEE BREAK



# FLOOR 1

## GENERAL FEATURES MADRID E ROOM

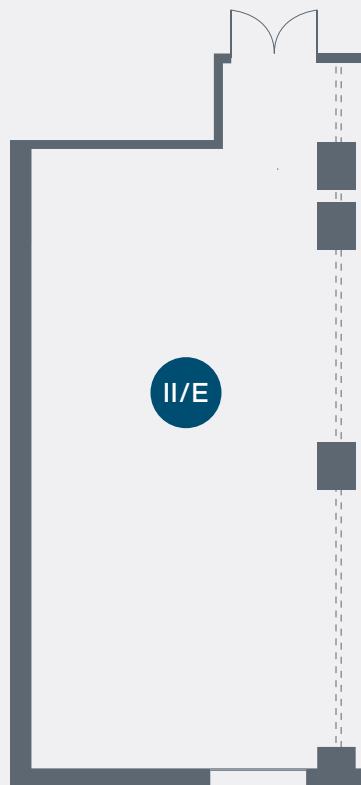

### DIMENSIONS

Area: 92 sqm  
 Column: -  
 Length: 14.5 m  
 Width: 6.3 m  
 Height (ceiling): 2.55 m

### ENTRYWAYS

Doors: 1  
 Door Height: 2 m  
 Door Width: 1.4 m

### AIR CONDITIONING AND LIGHTING

Air conditioned: Yes  
 Natural light: Yes  
 Blackout: Yes

### DATA AND VOICE

ISDN Connection: Yes  
 Telephone connection: Yes

### LINKS

Electrical Sockets: 8  
 TV Antennas: 1  
 Telephone sockets: 1  
 Internet sockets: 1  
 Voltage: 220  
 Amps: 10

### EQUIPMENT AVAILABLE INCLUDED IN THE PRICE:

Mineral water, pens, paper, screen, flipchart and projector

### EQUIPMENT AVAILABLE NOT INCLUDED IN THE PRICE:

Mixer, speakers and microphones (table, handheld, headset)



# FLOOR 1

## GENERAL FEATURES

### PARIS ROOM

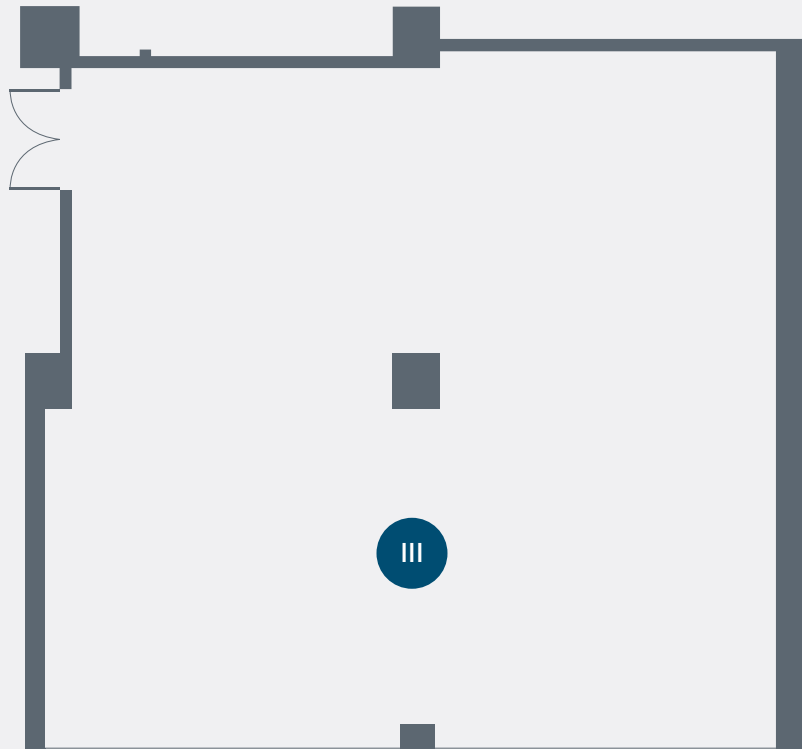

#### DIMENSIONS

Area: 156 sqm  
 Column: -  
 Length: 13 m  
 Width: 12 m  
 Height (ceiling): 2.6 m

#### ENTRYWAYS

Doors: 1  
 Door Height: 2 m  
 Door Width: 1.4 m

#### AIR CONDITIONING AND LIGHTING

Air conditioned: Yes  
 Natural light: Yes  
 Blackout: Yes

#### DATA AND VOICE

ISDN Connection: Yes  
 Telephone connection: Yes

#### LINKS

Electrical Sockets: 7  
 TV Antennas: 3  
 Telephone sockets: 1  
 Internet sockets: 1  
 Voltage: 220  
 Amps: 10

#### EQUIPMENT AVAILABLE INCLUDED IN THE PRICE:

Mineral water, pens, paper, screen, flipchart and projector

#### EQUIPMENT AVAILABLE NOT INCLUDED IN THE PRICE:

Mixer, speakers and microphones (table, handheld, headset)

\_ FOYER 1<sup>ST</sup> FLOOR



\_ LISBOA C ROOM



\_ COFFEE BREAK 1<sup>ST</sup> FLOOR TERRACE



# FLOOR 2

## ROOM CAPACITIES AND SPECIFICATIONS

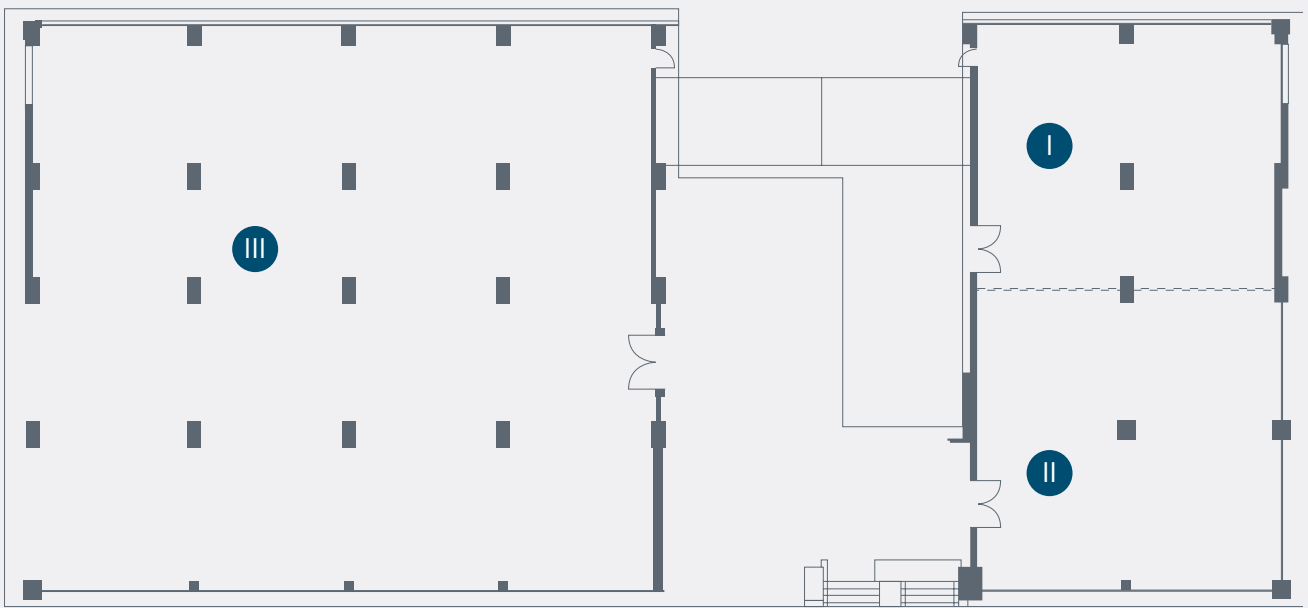

	Area	Dimensions	 Theatre	 Theatre double proj.	 Classroom	 Classroom double proj.	 Cabaret	 U Shape	 Cocktail	 Banquet	 Buffet
<b>I</b> Londres A	143 sqm	13 m x 11 m	100	120	60	-	42	30	100	70	50
<b>II</b> Londres B	159 sqm	13 m x 12.3 m	110	140	70	-	54	30	120	90	60
Londres A + B	302 sqm	12.6 m x 24 m	180	200	130	150	90	60	200	170	120
<b>III</b> Viena	618 sqm	26 m x 23.7 m	-	300	-	150	144	-	600	400	350



# FLOOR 2

## GENERAL FEATURES LONDRES A ROOM

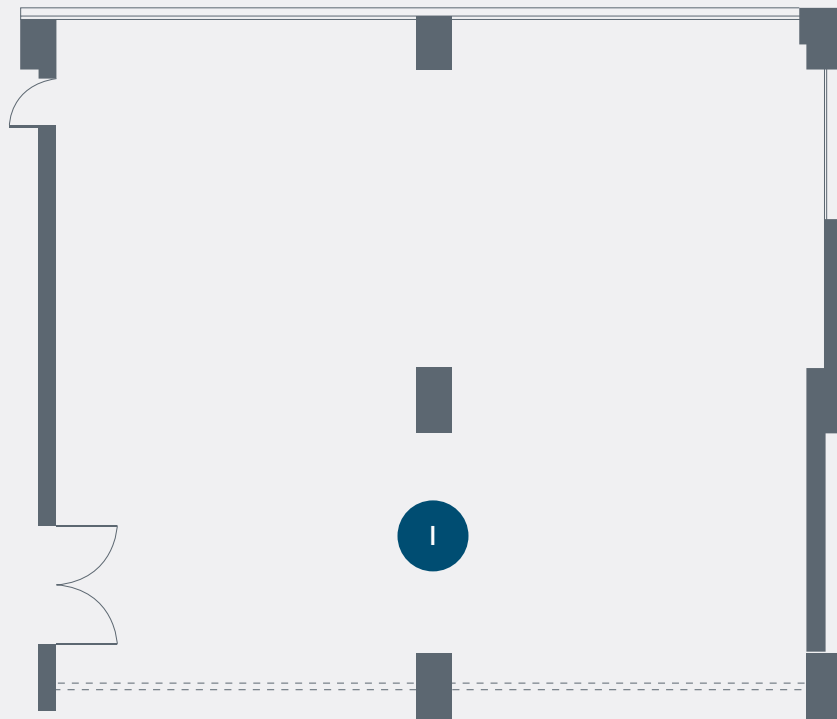

### DIMENSIONS

Area: 143 sqm  
Column: 1  
Length: 11 m  
Width: 13 m  
Height (ceiling): 2.5 m

### ENTRYWAYS

Doors: 1  
Door Height: 1.95 m  
Door Width: 1.4 m

### AIR CONDITIONING AND LIGHTING

Air conditioned: Yes  
Natural light: Yes  
Blackout: Yes

### DATA AND VOICE

ISDN Connection: Yes  
Telephone connection: Yes

### LINKS

Electrical Sockets: 7  
TV Antennas: 1  
Telephone sockets: 1  
Internet sockets: 1  
Voltage: 220  
Amps: 10

### EQUIPMENT AVAILABLE INCLUDED IN THE PRICE:

Mineral water, pens, paper, screen, flipchart and projector

### EQUIPMENT AVAILABLE NOT INCLUDED IN THE PRICE:

Mixer, speakers and microphones (table, handheld, headset)

# FLOOR 2

## GENERAL FEATURES LONDRES B ROOM

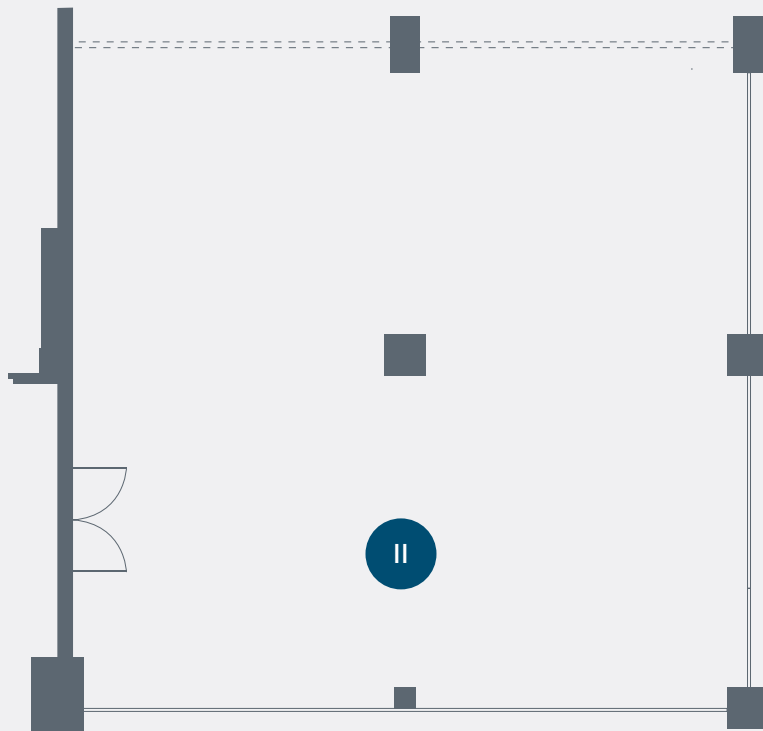

### DIMENSIONS

Area: 159 sqm  
 Column: 1  
 Length: 12.3 m  
 Width: 13 m  
 Height (ceiling): 2.5 m

### ENTRYWAYS

Doors: 1  
 Door Height: 1.95 m  
 Door Width: 1.4 m

### AIR CONDITIONING AND LIGHTING

Air conditioned: Yes  
 Natural light: Yes  
 Blackout: Yes

### DATA AND VOICE

ISDN Connection: Yes  
 Telephone connection: Yes

### LINKS

Electrical Sockets: 8  
 TV Antennas: 1  
 Telephone sockets: 1  
 Internet sockets: 1  
 Voltage: 220  
 Amps: 10

### EQUIPMENT AVAILABLE INCLUDED IN THE PRICE:

Mineral water, pens, paper, screen, flipchart and projector

### EQUIPMENT AVAILABLE NOT INCLUDED IN THE PRICE:

Mixer, speakers and microphones (table, handheld, headset)

# FLOOR 2

## GENERAL FEATURES

### VIENA ROOM

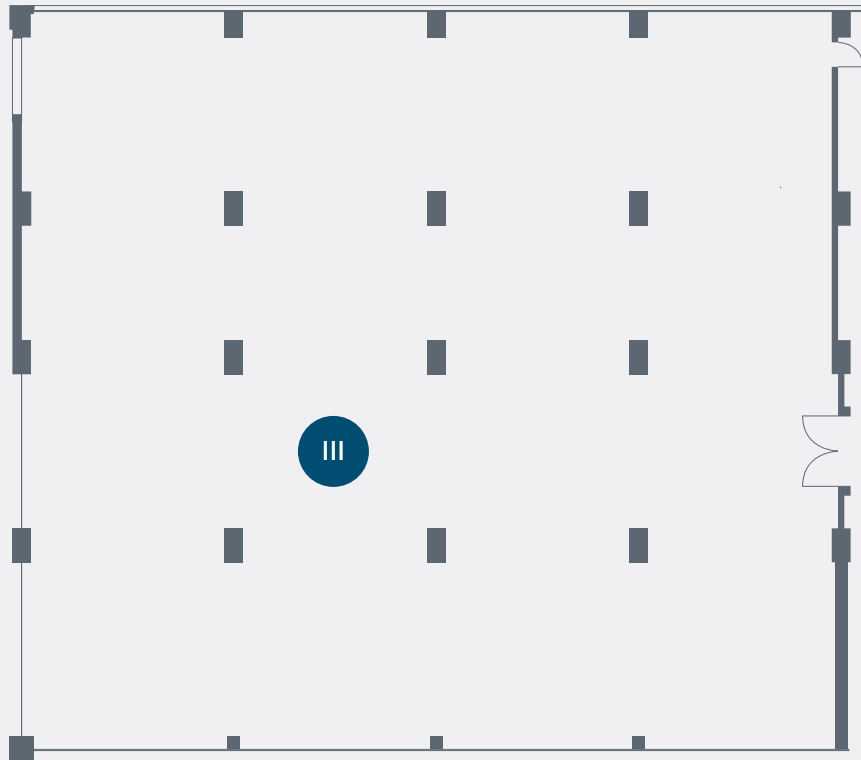

#### DIMENSIONS

Area: 618 sqm  
 Columns: 9  
 Length: 23.7 m  
 Width: 26 m  
 Height (ceiling): 2.5 m

#### ENTRYWAYS

Doors: 1  
 Door Height: 2 m  
 Door Width: 1.4 m

#### AIR CONDITIONING AND LIGHTING

Air conditioned: Yes  
 Natural light: Yes  
 Blackout: Yes

#### DATA AND VOICE

ISDN Connection: Yes  
 Telephone connection: Yes

#### LINKS

Electrical Sockets: 21  
 TV Antennas: 2  
 Telephone sockets: 2  
 Internet sockets: 2  
 Voltage: 220  
 Amps: 10

#### EQUIPMENT AVAILABLE INCLUDED IN THE PRICE:

Mineral water, pens, paper, screen, flipchart and projector

#### EQUIPMENT AVAILABLE

#### NOT INCLUDED IN THE PRICE:

Mixer, speakers and microphones (table, handheld, headset)



\_ VIENA TERRACE



\_ VIENA IN THEATRE





A photograph of a modern rooftop terrace. The terrace features dark, contemporary outdoor furniture, including tables and chairs. Large glass windows line the edge of the terrace, reflecting the surrounding city buildings. In the background, a prominent skyscraper with a distinctive cylindrical tower is visible against a clear sky. The overall atmosphere is sophisticated and urban.

# CORPORATE

Become a Corporate Client and enjoy all the benefits of an exclusive group.

# SANA METROPOLITAN CORPORATE

*WHERE YOUR SURROUNDINGS  
INSPIRE YOU TO WORK*

We know that time is important to you, but we also know that a corporate stay can be enhanced when associated with a unique experience. That's why we are dedicated to improving our global offering of products and services and responding to your needs and expectations, so you can enjoy your stay.

Here you'll find exceptional service, provided by a team of excellent professionals, always available to assist you.

Challenge us with your requests.  
At SANA Metropolitan we make your dreams come true.



## Services\_

Guest relations  
Room Service 24h  
Business Center  
Fitness Center  
Laundry / Dry Cleaning  
Meeting Rooms  
Free Wi-Fi

# SANA CARD

*ACCUMULATE EXCLUSIVE ADVANTAGES  
AS A PREFERRED CUSTOMER*

The SANA Card is designed exclusively for companies and their employees, so they can benefit from a 15% discount off the Best Available Rate on business or leisure trips throughout the SANA chain (Portugal, Germany, and Angola).

The SANA Card offers a wide range of exclusive benefits, such as additional discounts in restaurants, VIP treatment upon arrival, and free parking.



## Advantages and Benefits\_

15% on the Best Available Rate on accommodation in all SANA Hotels

10% discount in all SANA Hotels' restaurants and bars (up to 9 people)

10% discount on SAYANNA Wellness & SPA

10% Laundry and ironing service in the Hotels (whenever you stay)

VIP treatment upon arrival

Access to Digital Newspapers & Magazines

Access to SANIA, the digital assistant

Parking included (whenever you stay, and subject to hotel availability)

Dedicated team for your reservations through SANA Contact Center by phone (+351 212 468 688) or e-mail (reservas@sanahotels.com)



\_ LONDRES A+B ROOM



## MEETING SPACES

A selection of meeting spaces that fit your projects and an event team that's fully dedicated to you.

Total Area  
1750 sqm

12 rooms / with natural light or terrace / 600 people

\_ MADRID ROOM





\_ ASTROLÁBIO RESTAURANT



\_ WALL STREET BAR



## GASTRONOMIC OFFER

The Astrolábio Restaurant and terrace invite you on a trip to enjoy the flavours inspired by the Portuguese gastronomy.

At the Wall Street Bar, you can have a coffee, enjoy a glass of wine and a snack, or an evening drink.





# SOCIAL EVENTS & WEDDINGS

From the initial preparations, choice of space, decoration, menus, to the day of the big event, share your dream with us, and we will take care of everything for you, down to the smallest detail.

# EVENTS & WEDDINGS

*WE CREATE MEMORIES  
THAT LAST FOREVER*

Celebrate the most important day of your life, with the best flavours of Mediterranean cuisine, by the hand of our talented Chef.

Explore all the possibilities that our menus offer and delight everyone, with perfection at the table.

\_ CELEBRAÇÕES ANIVERSÁRIOS



- Birthdays
- Wedding Birthdays
- Cerimonies
- Wedding Parties
- Engagement Parties
- Religious Celebrations
- Celebrations
- Family and Friends Meetings
- Special Occasions

Events\_



A hand is shown reaching out from the right side of the frame, with fingers extended towards a glowing, wireframe globe on the left. The globe is composed of a complex network of lines and nodes, with some nodes highlighted in a bright blue color. The background is a dark blue gradient, also featuring a network of lines and nodes, creating a sense of digital connectivity and data flow. The overall aesthetic is futuristic and technological.

SAN.IA

WELCOME  
TO THE FUTURE

Hello!  
I'm SAN.IA, your Intelligent Assistant at SANA hotels. I am here to welcome you to SANA Metropolitan and put all the services of the hotel in your hands.

Find out how easy and fast it is to access all the hotel's services from your mobile device. Through our web app, you can fulfill your wishes, make special requests, and access information. Everything to maximize your time and enjoy every moment of your stay even more.

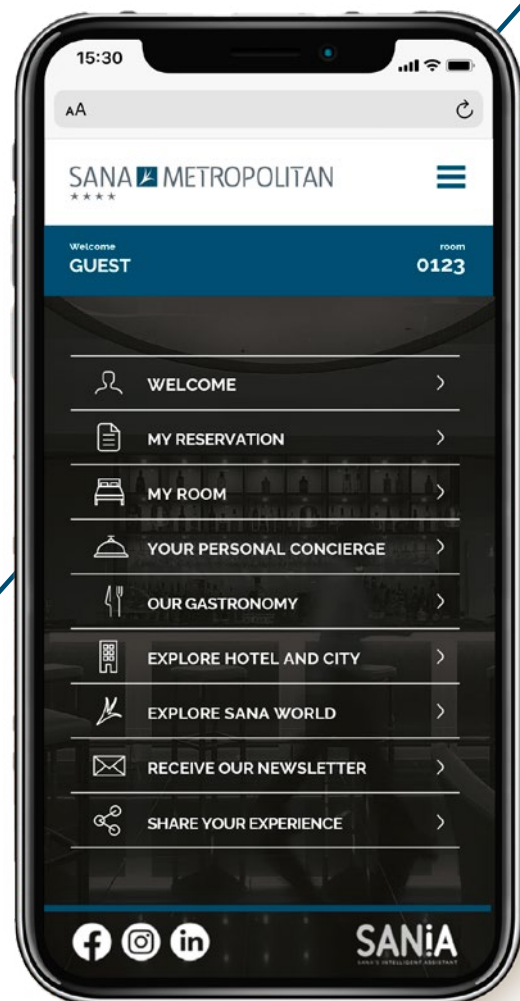

## What the SAN.IA can do for you\_

- Manage your booking
- Room Service
- Reservations and access to restaurant menus
- Services associated with your room
- Extra services
- Information about the SANA World



The background is a vertical composition. The left side shows a view of Earth from space, with a thin blue atmosphere and swirling white clouds over a dark blue ocean. The right side transitions into a dark, starry galaxy with bright, glowing orange and yellow clusters of stars. The text is overlaid on the left side of the image.

# SANA WORLD

A WORLD  
OF UNIQUE  
SENSATIONS

# SANA HOTELS

*THE PERFECT WORD TO LIVE  
UNIQUE SENSATIONS*

SANA Hotels are perfect for those who like to live unique sensations. More than a hotel chain, it's a set of unique concepts, a sensory project where each hotel unit has its own personality, nuances, flavor, and distinct tones.

We provide unforgettable moments, always ensuring Comfort and quality, exceeding your expectations.

Get to know all  
the other units  
that make up  
the SANA world\_





# SANA IN THE WORLD

*CONTINUOUSLY EXPANDING*



\* Soon

The SANA world is continuously expanding, signing unique hotels, each with its own personality, but all focused on providing excellent services. Discover all our units and projects for the future in [sana-hotels.com](https://sana-hotels.com).

# TALK TO US

---

## SANA METROPOLITAN

R. Soeiro Pereira Gomes Parcela 2,  
1600-198 Lisboa

T +351 217 982 500

E [sanametropolitan@sanahotels.com](mailto:sanametropolitan@sanahotels.com)

---

[SANAHOTELS.COM](https://www.sanahotels.com)

